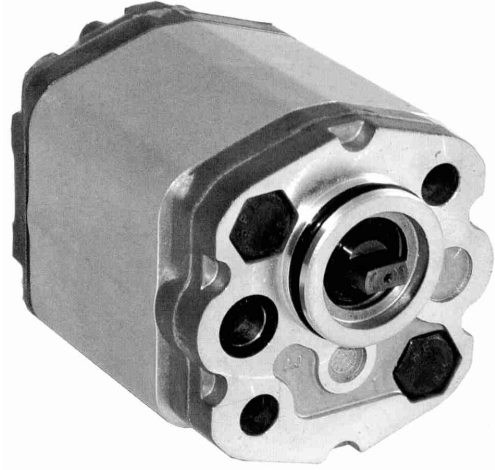
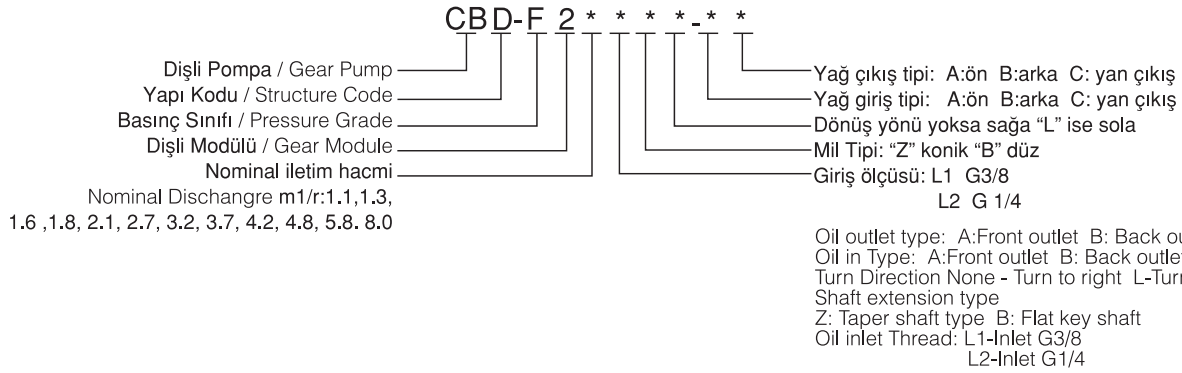

CBD-F2 SERİSİ DİŞLİ POMPA / CBD-F2 SERIES GEAR PUMP**UYGULAMA VE ÖZELLİKLER / APPLICATION AND FEATURES**

CBD-F2 dişli pompaları hidrolik sistemlerin dinamik parçalarıdır. DU rulmanlı, düz yataklamalı, yüksek mukavemetli alüminyum alaşımlı, yüksek hassasiyet sunar. Basit yapılı, hafif, yüksek verimli, düşük sesli ve yüksek güvenilirliğe sahiptir. Geniş bir kullanım alanı vardır. Kamyon, inşaat makineler, kaldırıncı ve taşıyıcılar gibi yerlerde kullanılır.

CBD-F2 series gear pump is the dynamic component of the hydraulic system. It features high precision gears, high strength aluminium alloy shell, float bushings, and DU bearings. It has the characteristics of simple structure, light weight, high efficiency, low noise, and high reliability, etc. It is widely used in the hydraulic system of truck, construction machinery, lift and transport machinery, mine machinery, and agriculture machinery, etc.

**MODEL KODU / MODEL CODE****ÖZELLİKLER / SPECIFICATION**

Model	Disp. (m ³ /r)	Basınç(Mpa) Pressure(Mpa)		Hız(rpm) Speed(r/min)			Kullanılan yağ Working oil	Filtre Hassasiyeti (µm) Filter Precision	Yağ Sıcaklığı (°C) oil temperature	Hacim Verimi Volumetric efficiency (%)	Güç Input Power (KW)	Ağırlık Weight (Kg)
		Rated normal	Max.	Rated	Max.	Min.						
CBD-F201.1	1.1	20	25	2000	6000	600	L-HM46 GB/T 7631.2-87	≤ 25	-20~80	≥ 93	0.86	0.77
CBD-F201.3	1.3										1.02	0.79
CBD-F201.6	1.6										1.25	0.80
CBD-F201.8	1.8										1.45	0.81
CBD-F202.1	2.1										1.65	0.82
CBD-F202.7	2.7										2.12	0.85
CBD-F203.2	3.2										2.51	0.87
CBD-F203.7	3.7										2.90	0.90
CBD-F204.2	4.2										3.29	0.92
CBD-F204.8	4.8										3.76	0.95
CBD-F205.8	5.8	16	20	2900	2100						4.55	1.00
CBD-F208.0	8.0										6.27	1.10

CBD-F2 SERİSİ DİŞLİ POMPALAR / CBD-F2 SERIES GEAR PUMP

MONTAJ ÖLÇÜLERİ / INSTALLATION DIMENSIONS

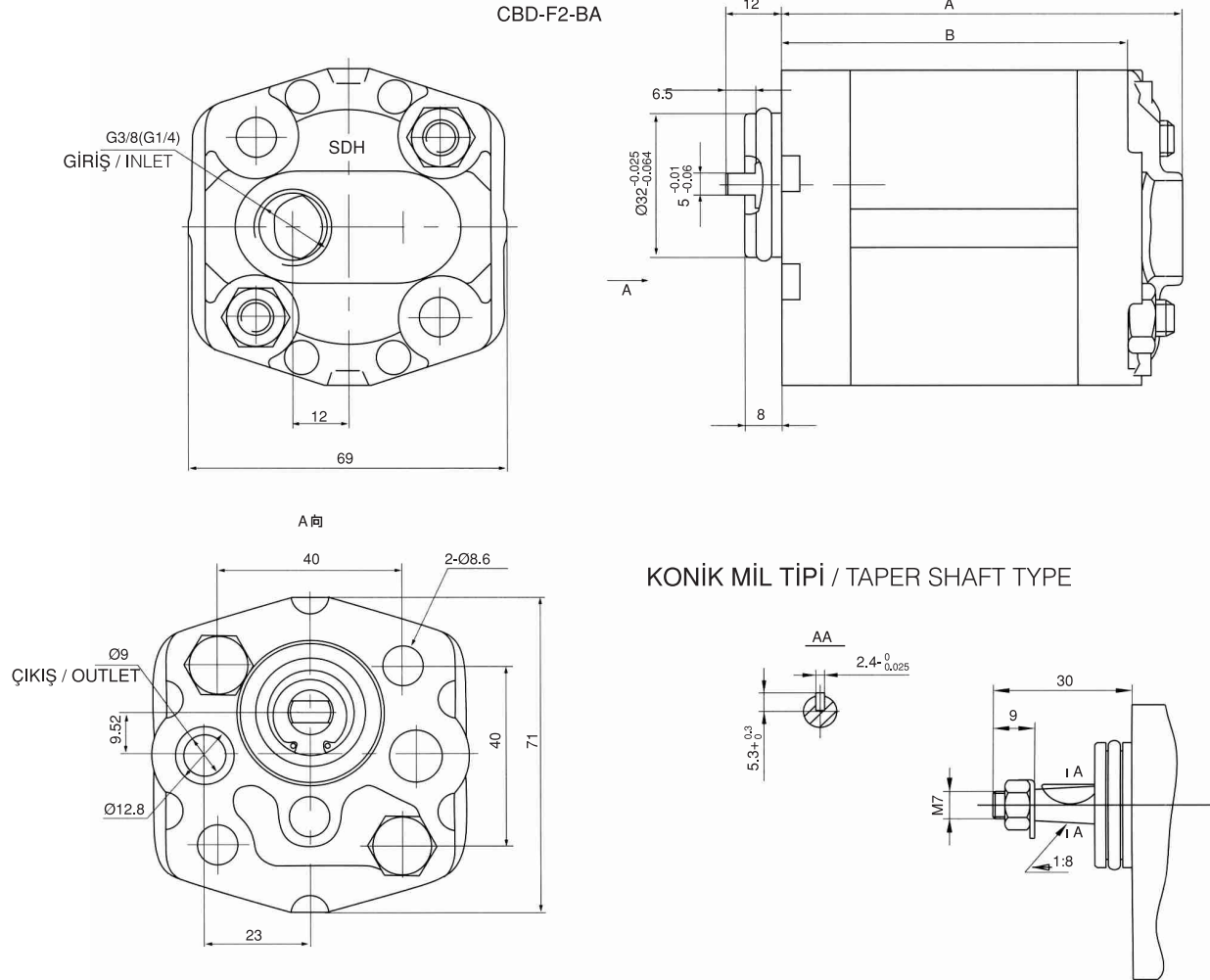

Model	A(mm)	B(mm)
CBD-F201.1	74	62
CBD-F201.3	75	63
CBD-F201.6	76	64
CBD-F202.1	78	66
CBD-F202.7	80	68
CBD-F203.2	82	70
CBD-F203.7	84	72
CBD-F204.2	86	74
CBD-F204.8	88	76
CBD-F205.8	92	80
CBD-F208.0	100	88